

METRIC MALE STUD COUPLINGS

THREAD: BSP CYLINDRICAL (UNI ISO 228)
S SERIES

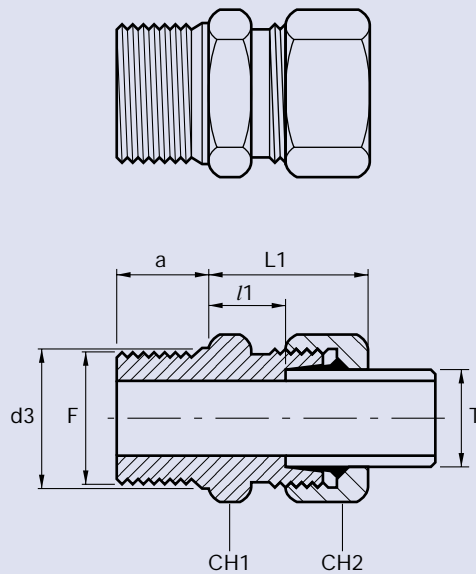

MALE STUD COUPLINGS

Series	NP	ØT	Part N°	ØF	CH1	CH2	a	d3	L1	l1
S	630	6	MMC6-4	1/4"	19	17	12	18	28	13
S	630	8	MMC8-4	1/4"	19	19	12	18	30	15
S	630	8	MMC8-6	3/8"	22	19	12	22	30.5	15.5
S	630	10	MMC10-6	3/8"	22	22	12	22	31	15
S	630	10	MMC10-8	1/2"	27	22	14	26	33.5	17.5
S	630	12	MMC12-4	1/4"	22	24	12	18	32.5	16.5
S	630	12	MMC12-6	3/8"	22	24	12	22	33	17
S	630	12	MMC12-8	1/2"	27	24	14	26	33.5	17.5
S	630	14	MMC14-6	3/8"	24	27	12	22	36.5	18.5
S	630	14	MMC14-8	1/2"	27	27	14	26	37	19
S	400	16	MMC16-6	3/8"	27	30	12	22	37	18.5
S	400	16	MMC16-8	1/2"	27	30	14	26	37	18.5
S	400	16	MMC16-12	3/4"	32	30	16	32	39	20.5
S	400	20	MMC20-8	1/2"	32	36	14	26	42	20.5
S	400	20	MMC20-12	3/4"	32	36	16	32	42	20.5
S	400	20	MMC20-16	1"	41	36	18	39	44	22.5
S	400	25	MMC25-12	3/4"	41	46	16	32	47	23
S	400	25	MMC25-16	1"	41	46	18	39	47	23
S	250	30	MMC30-16	1"	46	50	18	39	50	23.5
S	250	30	MMC30-20	1 1/4"	50	50	20	49	50	23.5
S	250	38	MMC38-16	1"	55	60	18	39	57	26
S	250	38	MMC38-24	1 1/2"	55	60	22	55	57	26
S	250	38	MMC38-20	1 1/4"	55	60	20	49	57	26

NOTE: THE BSP THREADS ARE ALL COUNTERSUNK 60°, SUITABLE FOR HOSE CONNECTION.

Part numbers indicated are for **Carbon Steel Couplings** only.
For **316 Stainless Steel Couplings**, add suffix **SS** to part number.