

# METRIC MALE STUD COUPLINGS – WD

THREAD: METRIC PARALLEL

WD CAPTIVE SEAL – PERBUNAN OR VITON

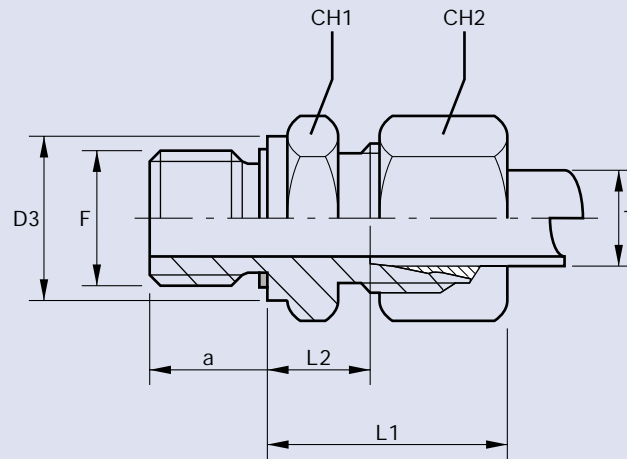

Series	NP	ØT	Part N°	F	L1	L2	a	CH1	CH2	D3
L	315	6	MMC6-10MLWD	10x1	23	8.5	8	14	14	14
L	315	8	MMC8-12MLWD	12x1.5	25	10	12	17	17	17
L	315	10	MMC10-14MLWD	14x1.5	26	11	12	19	19	19
L	315	12	MMC12-16MLWD	16x1.5	27	12.5	12	22	22	22
L	315	15	MMC15-18MLWD	18x1.5	29	14	14	24	27	24
L	160	18	MMC18-22MLWD	22x1.5	31	14.5	14	27	32	27
L	160	22	MMC22-26MLWD	26x1.5	33	16.5	16	32	36	32
L	160	28	MMC28-33MLWD	33x2	34	17.5	18	41	41	40
L	160	35	MMC35-42MLWD	42x2	39	17.5	20	50	50	50
L	160	42	MMC42-48MLWD	48x2	42	19	22	55	60	55
S	630	6	MMC6-12MWD	12x1.5	28	13	12	17	17	17
S	630	8	MMC8-14MWD	14x1.5	30	15	12	19	19	19
S	630	10	MMC10-16MWD	16x1.5	31	15	12	22	22	22
S	630	12	MMC12-18MWD	18x1.5	33	17	12	24	24	24
S	630	14	MMC14-20MWD	20x1.5	37	19	14	27	27	26
S	630	16	MMC16-22MWD	22x1.5	37	18.5	14	27	30	27
S	630	20	MMC20-27MWD	27x2	42	20.5	16	32	36	32
S	630	25	MMC25-33MWD	33x2	47	23	18	41	46	40
S	630	30	MMC30-42MWD	42x2	50	23.5	20	50	50	50
S	315	38	MMC38-48MWD	48x2	57	26	22	55	60	55

Perbunan captive seal temperature range -20°C to +90°C. (Viton captive seal temperature range -20°C to +200°C on request).

Please Note-Metric thread male stud coupling also available without WD seal to form A.

Part numbers indicated are for **Carbon Steel Couplings** only.  
For **316 Stainless Steel Couplings**, add suffix **SS** to part number.