

IMPERIAL BULKHEAD COUPLINGS

FOR O.D. & N.B. TUBES

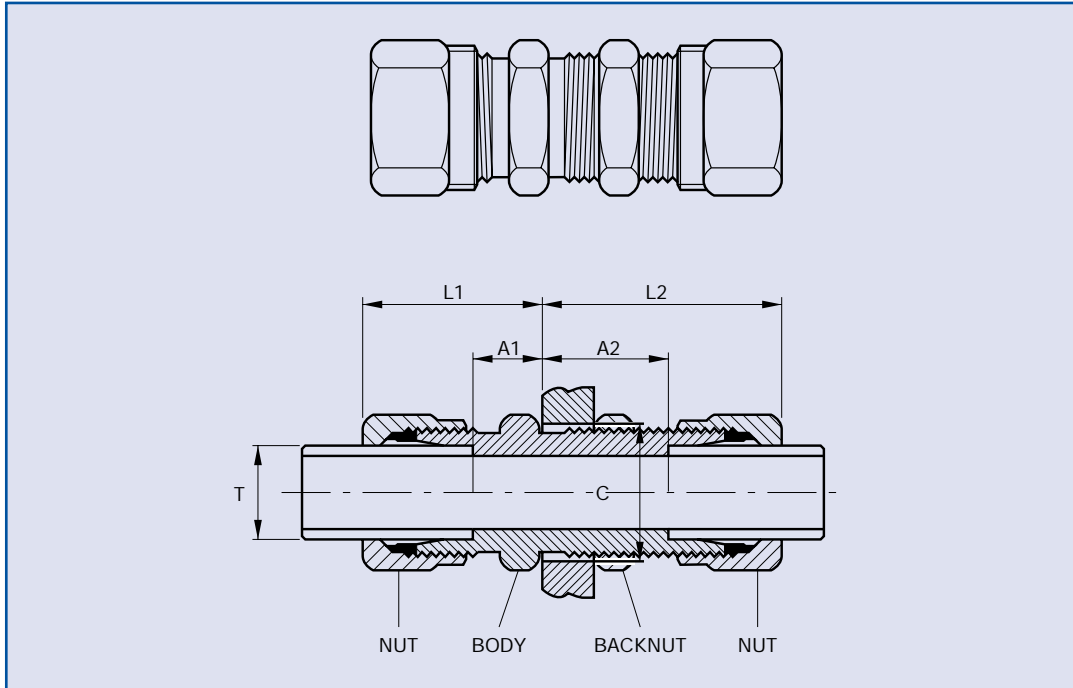

BULKHEAD COUPLINGS



O.D. TUBES

Part No.	Tube Dia. T.	Hexagons A/F		Tube Abutment		Overall Length		Clearance Hole dia. C.
		Nut	Body & Backnut	A1.	A2.	L1.	L2.	
BH4	1/4"	.710"	.820"	5/32"	29/32"	1"	1 5/8"	9/16"
BH5	5/16"	.710"	.820"	5/16"	19/16"	1 1/32"	1 21/32"	19/32"
BH6	3/8"	.820"	.920"	3/8"	1"	1 3/32"	1 23/32"	1 1/16"
BH8	1/2"	.920"	1.10"	13/32"	1 1/32"	1 5/8"	1 25/32"	13/16"
BH10	5/8"	1.10"	1.20"	3/8"	1"	1 5/32"	1 25/32"	15/16"
BH12	3/4"	1.20"	1.375"	7/16"	1 1/16"	1 1/4"	1 7/8"	1 1/16"
BH14	7/8"	1.375"	1.48"	1/2"	1 1/8"	1 3/8"	2"	1 3/16"
BH16	1"	1.67"	1.86"	19/32"	1 1/32"	1 17/32"	2 5/32"	1 7/16"
BH20	1 1/4"	2.05"	2.05"	1 1/16"	1 3/16"	1 21/32"	2 9/32"	1 11/16"
BH24	1 1/2"	2.22"	2.41"	3/4"	1 3/8"	1 13/16"	2 7/16"	2"

N.B. TUBES

Part No.	N.B. Tube Size T.	Hexagons A/F		Tube Abutment		Overall Length		Clearance Hole dia. C.
		Nut	Body & Backnut	A1.	A2.	L1.	L2.	
NBH2	1/8"	.820"	1.01"	13/32"	1 1/32"	1 5/32"	1 25/32"	3/4"
NBH4	1/4"	1.10"	1.20"	3/8"	1"	1 5/32"	1 25/32"	15/16"
NBH6	3/8"	1.20"	1.375"	7/16"	1 1/16"	1 1/4"	1 7/8"	1 1/16"
NBH8	1/2"	1.375"	1.48"	1/2"	1 1/8"	1 3/8"	2"	1 3/16"
NBH12	3/4"	1.67"	1.86"	5/8"	1 1/4"	1 5/8"	2 1/4"	1 7/16"
NBH16	1"	2.05"	2.05"	1 1/16"	1 3/16"	1 21/32"	2 9/32"	1 11/16"
NBH20	1 1/4"	2.58"	2.76"	1 3/16"	1 7/16"	1 29/32"	2 17/32"	2 1/4"
NBH24	1 1/2"	3.02"	3.02"	1 3/16"	1 7/16"	2"	2 5/8"	2 1/2"

The above couplings are suitable for bulkheads with a Maximum thickness of 1/2".

Part numbers indicated are for **Carbon Steel Couplings** only.

For **316 Stainless Steel Couplings**, add suffix **SS** to part number.