

# METRIC WELDING BOSSES

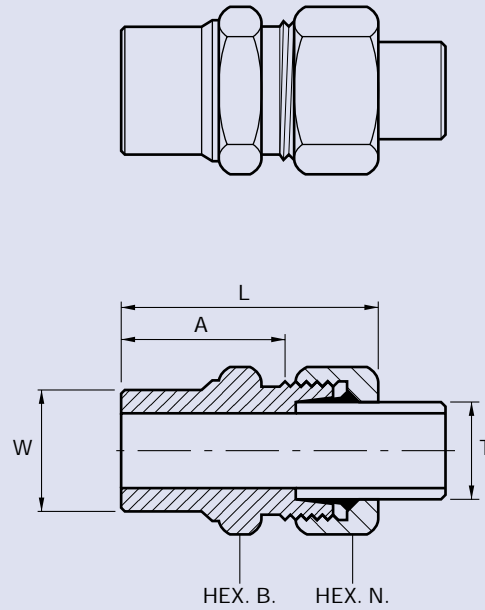

Series	Tube Ø (T)	Part N°	Boss Ø (W)	Nut Hex N	Body Hex (B)	Abut Length (A)	Overall Length (L)
L	6	MWB6L	10	14	12	14	29
L	8	MWB8L	12	17	14	16	31
L	10	MWB10L	14	19	17	18	33
L	12	MWB12L	16	22	19	18	33
L	15	MWB15L	19	27	22	22	37
L	18	MWB18L	22	32	27	23.5	40
L	22	MWB22L	27	36	32	28.5	45
L	28	MWB28L	32	41	41	30.5	47
L	35	MWB35L	40	50	46	32.5	54
L	42	MWB42L	46	60	55	35	58
S	6	MWB6	11	17	14	19	34
S	8	MWB8	13	19	17	21	36
S	10	MWB10	15	22	19	22.5	39
S	12	MWB12	17	24	22	24.5	41
S	14	MWB14	19	27	24	27	45
S	16	MWB16	21	30	27	26.5	45
S	20	MWB20	26	36	32	29.5	51
S	25	MWB25	31	46	41	32	56
S	30	MWB30	36	50	46	35.5	62
S	38	MWB38	44	60	55	38	69

Part numbers indicated are for **Carbon Steel Couplings** only.

For **316 Stainless Steel Couplings**, add suffix **SS** to part number.