

IMPERIAL STUD STANDPIPE ADAPTORS

FOR O.D. & N.B. FITTINGS

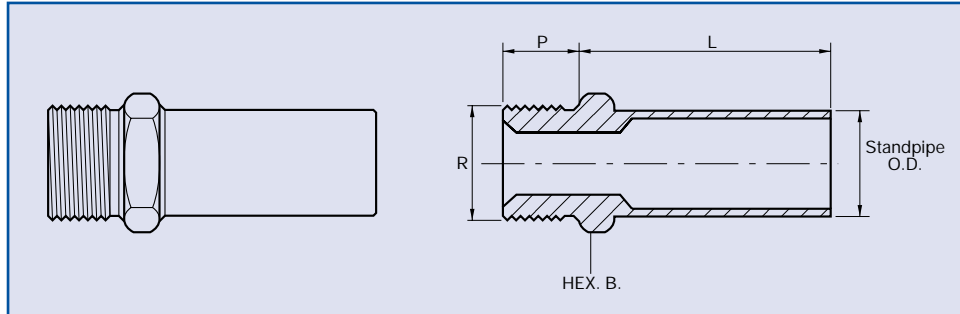

O.D. TUBES

Part No.	BSP Thread R.	O.D. of Standpipe	Body Hexagon B.	P.	L.
SA2-4	1/8"	1/4"	.625"	3/8"	1 1/4"
SA4-4	1/4"	1/4"	.710"	7/16"	1 1/4"
SA4-5	1/4"	5/16"	.710"	7/16"	1 1/32"
SA4-6	1/4"	3/8"	.710"	7/16"	1 1/16"
SA6-6	3/8"	3/8"	.920"	1/2"	1 3/8"
SA6-8	3/8"	1/2"	.920"	1/2"	1 1/16"
SA8-8	1/2"	1/2"	1.10"	5/8"	1 1/16"
SA8-10	1/2"	5/8"	1.10"	5/8"	1 1/16"
SA8-12	1/2"	3/4"	1.10"	5/8"	1 5/8"
SA12-12	3/4"	3/4"	1.30"	3/4"	1 3/4"
SA12-14	3/4"	7/8"	1.30"	3/4"	1 13/16"
SA12-16	3/4"	1"	1.30"	3/4"	1 15/16"
SA16-16	1"	1"	1.67"	7/8"	2"
SA16-20	1"	1 1/4"	1.67"	7/8"	2 1/32"
SA20-20	1 1/4"	1 1/4"	2.05"	1"	2 1/32"
SA20-24	1 1/4"	1 1/2"	2.05"	1"	2 9/16"
SA24-24	1 1/2"	1 1/2"	2.22"	1"	2 3/8"

N.B. TUBES

Part No.	BSP Thread R.	N.B. Size Standpipe	Body Hexagon B.	P.	L.
NSA4-4	1/4"	1/4"	.710"	7/16"	1 1/16"
NSA6-4	3/8"	1/4"	.920"	1/2"	1 1/2"
NSA6-6	3/8"	3/8"	.920"	1/2"	1 1/2"
NSA8-6	1/2"	3/8"	1.10"	5/8"	1 1/16"
NSA8-8	1/2"	1/2"	1.10"	5/8"	1 11/16"
NSA12-8	3/4"	1/2"	1.30"	3/4"	1 13/16"
NSA12-12	3/4"	3/4"	1.30"	3/4"	2 1/16"
NSA12-16	3/4"	1"	1.375"	3/4"	2 1/32"
NSA16-12	1"	3/4"	1.67"	7/8"	2 1/16"
NSA16-16	1"	1"	1.67"	7/8"	2 1/32"
NSA16-20	1"	1 1/4"	1.86"	7/8"	2 13/32"
NSA20-16	1 1/4"	1"	2.05"	1"	2 1/32"
NSA20-20	1 1/4"	1 1/4"	2.05"	1"	2 13/32"
NSA24-24	1 1/2"	1 1/2"	2.22"	1"	2 9/16"

NOTE: THE BSP THREADS ARE COUNTERSUNK 60°, SUITABLE FOR HOSE CONNECTION.

Alternatively supplied fitted with nut and ferrule, at extra cost, on standpipe end.

Part numbers indicated are for **Carbon Steel Couplings** only.

For **316 Stainless Steel Couplings**, add suffix **SS** to part number.