

METRIC REDUCING ADAPTORS

S SERIES

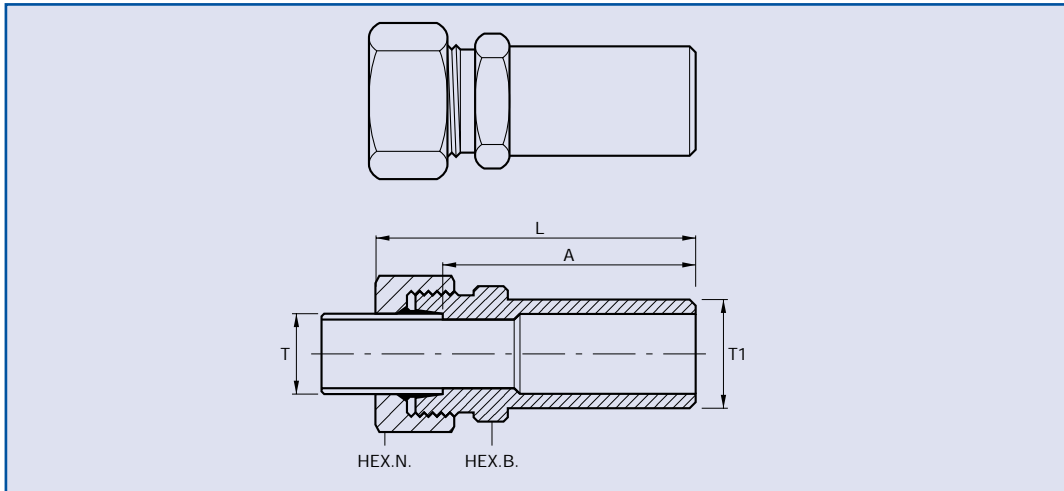

Series	ØT	Part N°	ØT1	Nut Hex. N	Body Hex. B	A	L
S	6	MRA6-8	8	17	14	31	46
S	8	MRA8-10	10	19	17	33	48
S	6	MRA6-10	10	17	14	32	47
S	10	MRA10-12	12	22	19	34.5	51
S	8	MRA8-12	12	19	17	35	50
S	6	MRA6-12	12	17	14	33	48
S	12	MRA12-14	14	24	22	38.5	55
S	10	MRA10-14	14	22	19	36.5	53
S	8	MRA8-14	14	19	17	37	52
S	6	MRA6-14	14	17	17	37	52
S	14	MRA14-16	16	27	24	40	58
S	12	MRA12-16	16	24	22	38.5	55
S	10	MRA10-16	16	22	19	36.5	53
S	8	MRA8-16	16	19	17	37	52
S	6	MRA6-16	16	17	17	37	52
S	16	MRA16-20	20	30	27	44.5	63
S	14	MRA14-20	20	27	24	45	63
S	12	MRA12-20	20	24	22	43.5	60
S	10	MRA10-20	20	22	22	43.5	60
S	8	MRA8-20	20	19	22	44	59
S	20	MRA20-25	25	36	32	49.5	71
S	16	MRA16-25	25	30	27	47.5	66
S	14	MRA14-25	25	27	27	48	66
S	12	MRA12-25	25	24	27	46.5	63
S	10	MRA10-25	25	22	27	46.5	63
S	25	MRA25-30	30	46	41	54	78
S	20	MRA20-30	30	36	32	51.5	73
S	16	MRA16-30	30	30	32	51.5	70
S	14	MRA14-30	30	27	32	52	70
S	12	MRA12-30	30	24	32	50.5	67
S	30	MRA30-38	38	50	46	58.5	85
S	25	MRA25-38	38	46	41	58	82
S	20	MRA20-38	38	36	41	57.5	79
S	16	MRA16-38	38	30	41	57.5	76

Nut and ferrule can be pre-assembled if required.

Part numbers indicated are for **Carbon Steel Couplings** only.

For **316 Stainless Steel Couplings**, add suffix **SS** to part number.