

SOCKET SCREW PLUG

BSP & METRIC THREADS
WD CAPTIVE SEAL

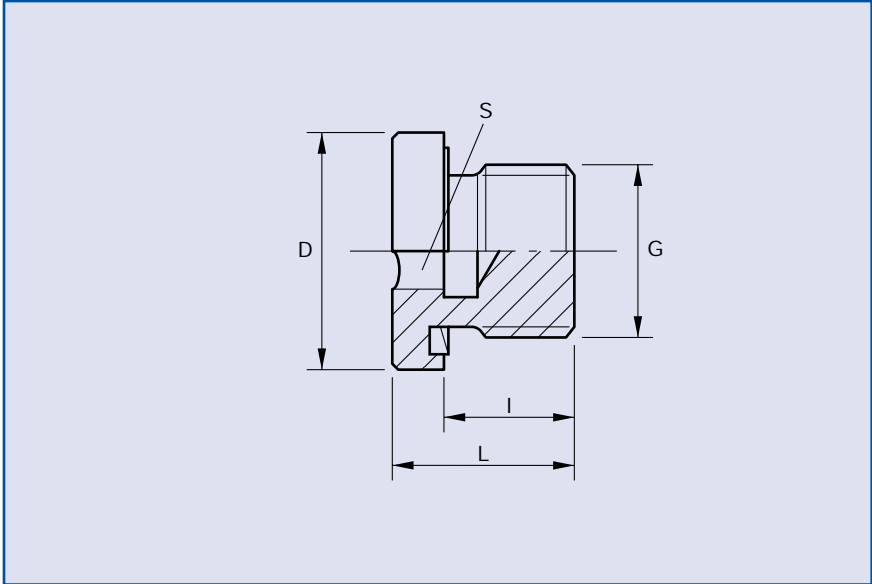

SOCKET SCREW PLUGS



NP	Part N°	G	L	i	S	D
400	SSP2	1/8" A	12	8	5	14
400	SSP4	1/4" A	17	12	6	18.9
400	SSP6	3/8" A	17	12	8	22
400	SSP8	1/2" A	19	14	10	26.9
400	SSP12	3/4" A	21	16	12	32
400	SSP16	1" A	22.5	16	17	39.9
250	SSP20	1 1/4" A	22.5	16	22	49.9
250	SSP24	1 1/2" A	22.5	16	24	55
400	MSSP10	M10 x 1	12	8	5	14
400	MSSP12	M12 x 1.5	17	12	6	17
400	MSSP14	M14 x 1.5	17	12	6	19
400	MSSP16	M16 x 1.5	17	12	8	21.9
400	MSSP18	M18 x 1.5	17	12	8	23.9
400	MSSP20	M20 x 1.5	19	14	10	25.9
400	MSSP22	M22 x 1.5	19	14	10	27
400	MSSP26	M26 x 1.5	21	16	12	31.9
400	MSSP27	M27 x 2	21	16	12	32
400	MSSP33	M33 x 2	22.5	16	17	39.9
250	MSSP42	M42 x 2	22.5	16	22	49.9
250	MSSP48	M48 x 2	22.5	16	24	55

Perbunan captive seal temperature range -20°C to +90°C. (Viton captive seal temperature range -20°C to +20°C on request).

Part numbers indicated are for **Carbon Steel Couplings** only.
For **316 Stainless Steel Couplings**, add suffix **SS** to part number.